

HY'S STEAK HOUSE FLOOR PLAN

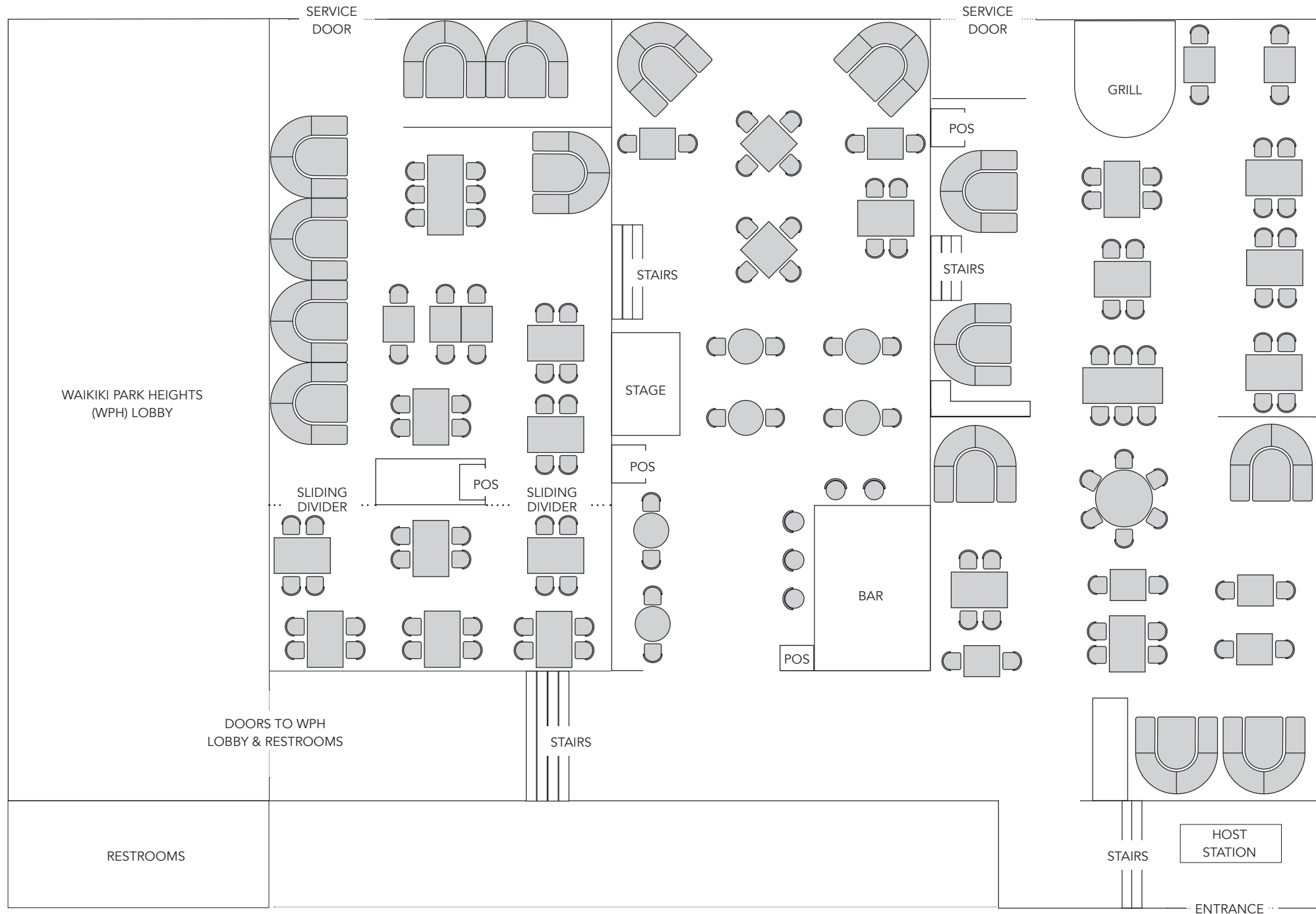

LOWER LIBRARY ROOM

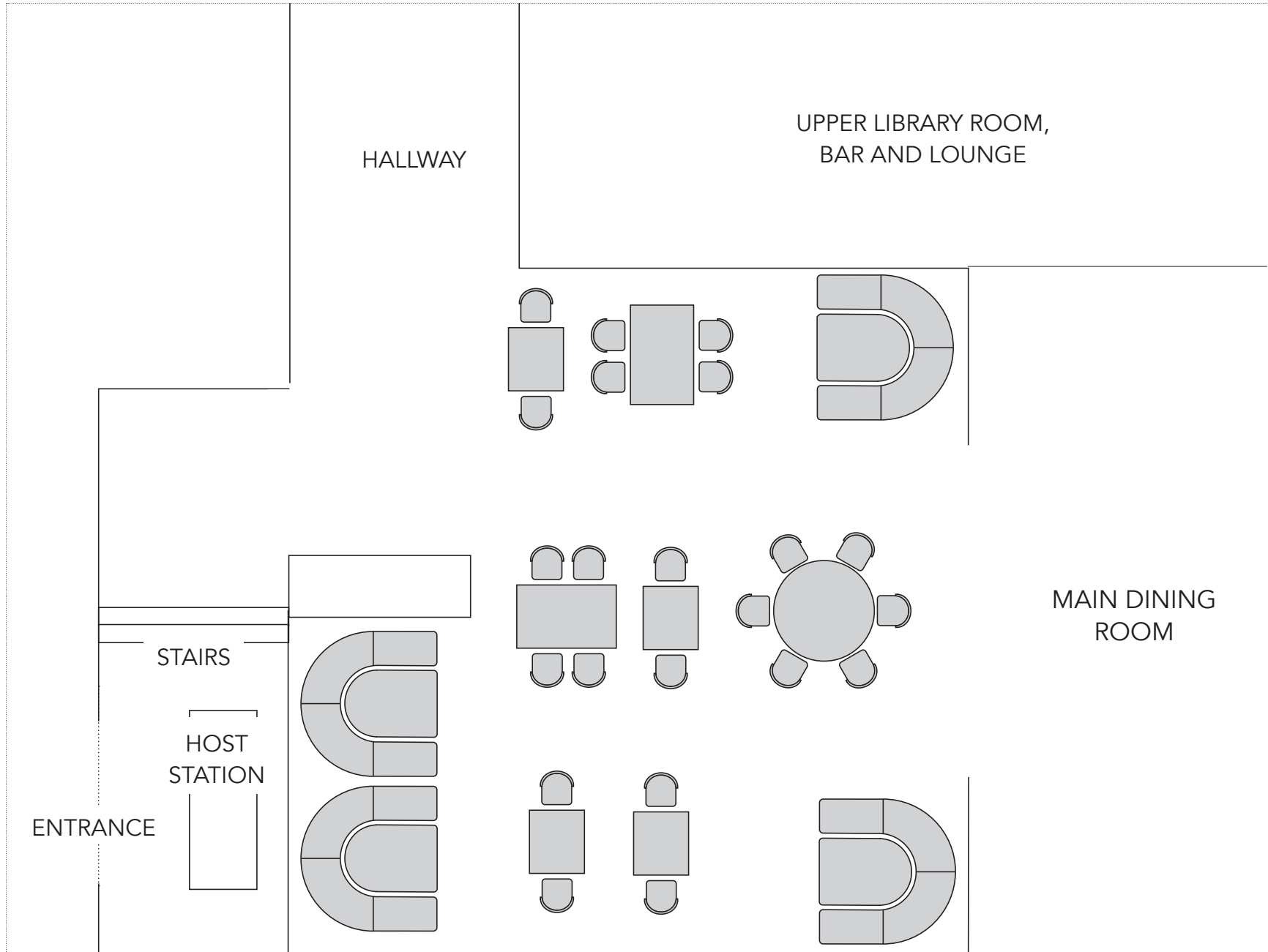

MAIN DINING ROOM

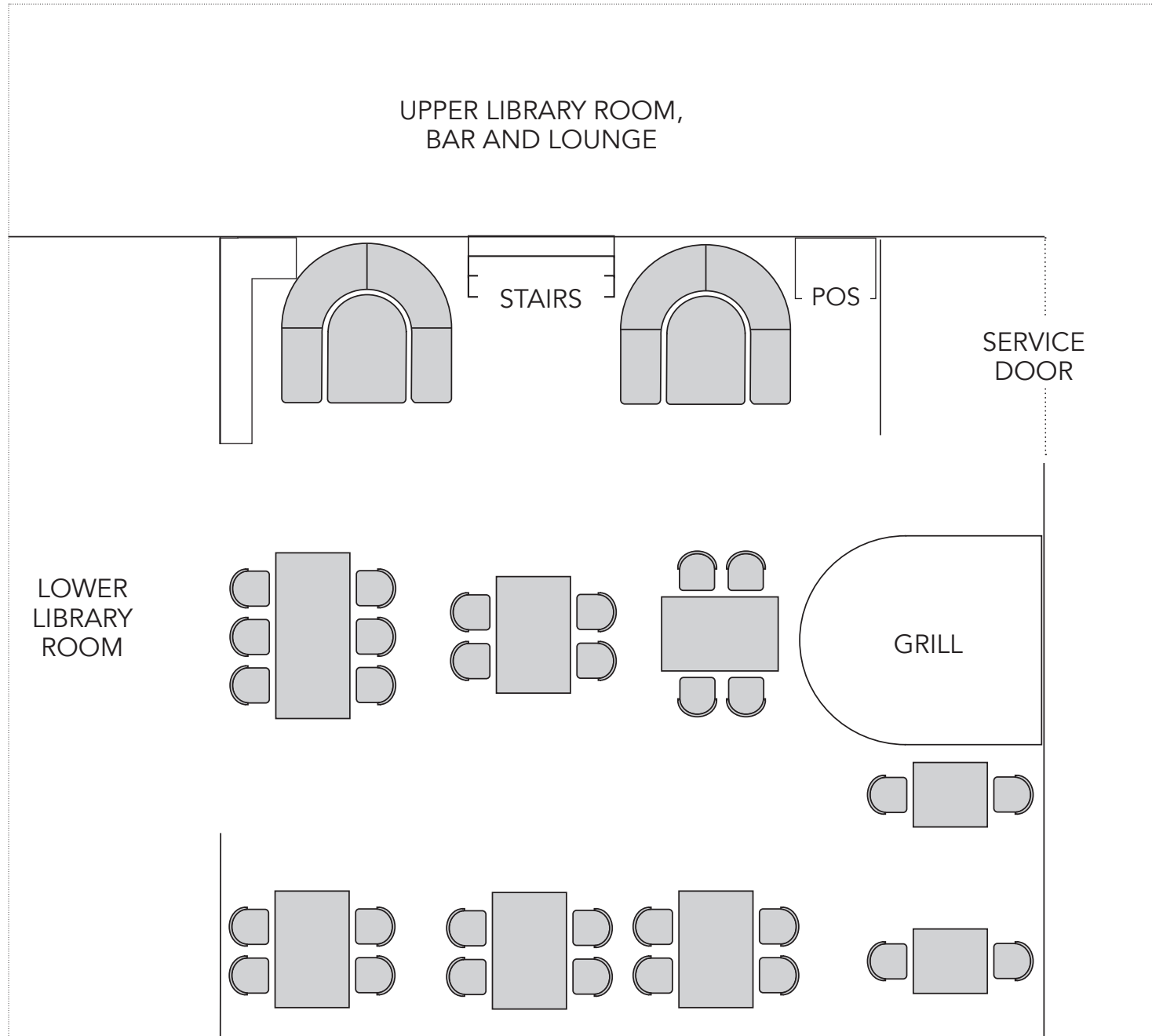

MAIN DINING ROOM | TOTAL PAX: 48

UPPER LIBRARY, BAR AND LOUNGE

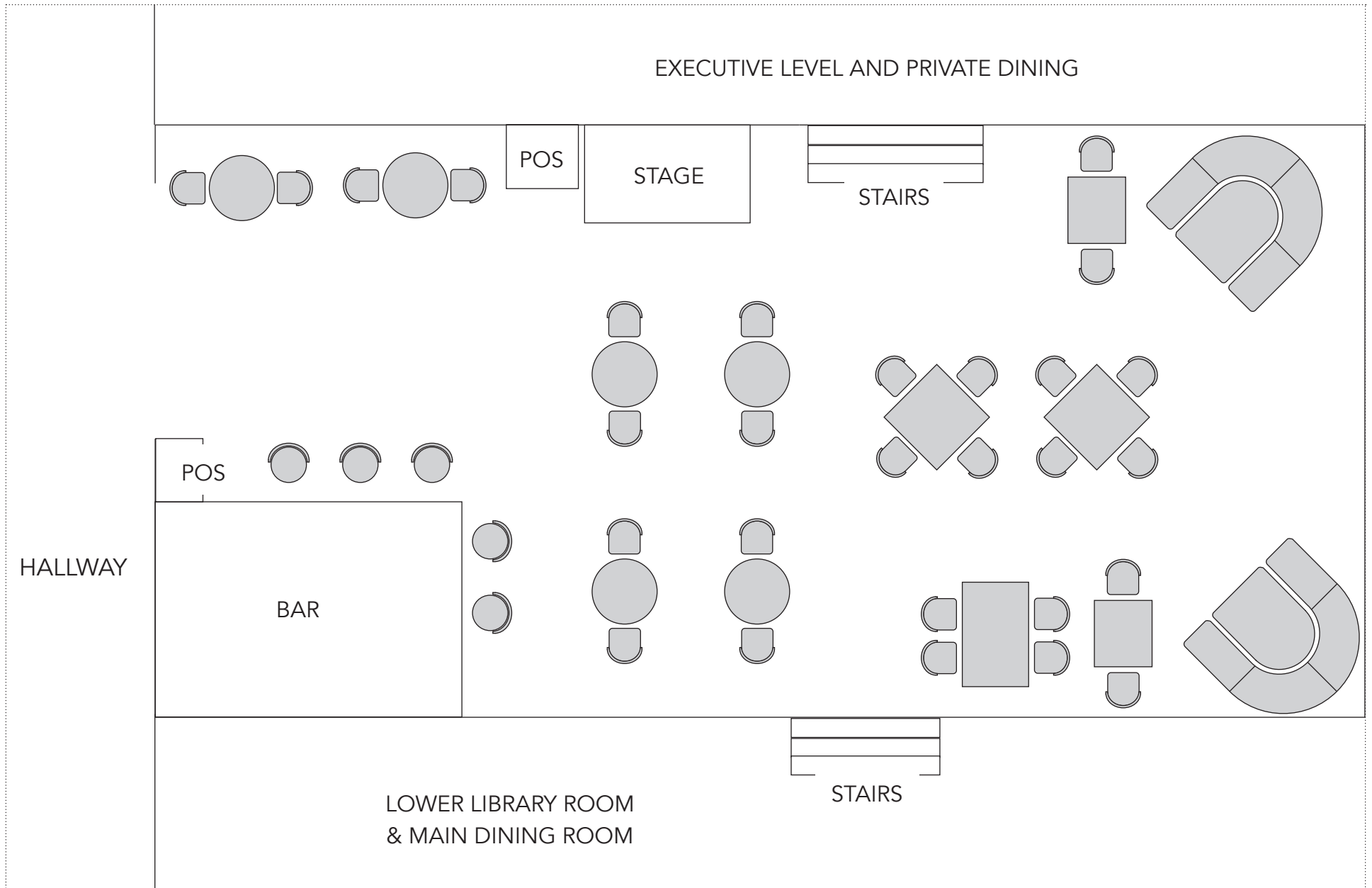

BOX | TOTAL PAX: 22

BAR & LOUNGE | BAR PAX: 5 LOUNGE PAX: 16

EXECUTIVE LEVEL AND PRIVATE DINING ROOM

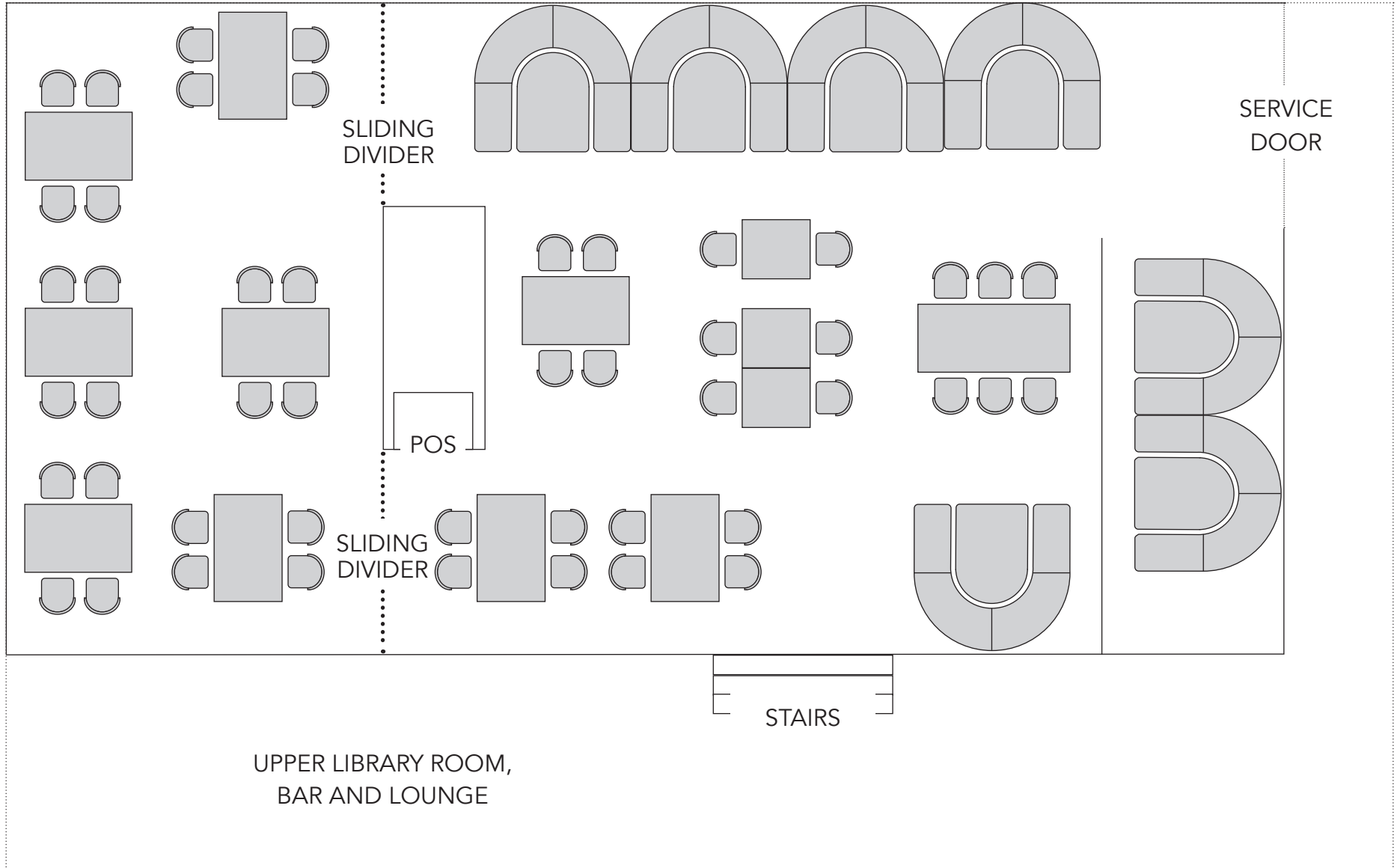

EXEC LVL FULL | PARTIAL BUYOUT: 63
PRIVATE DINING ROOM: 24